



36 Betjeman Close

Pinner, HA5 5SA

£259,995



36 Betjeman Close

Pinner, HA5 5SA

A Spacious 2 bedroom First Floor RETIREMENT flat recently re decorated throughout and conveniently situated in this sought after development in this quiet cul de sac.

The accommodation comprises Generous Lounge, Spacious Kitchen, 2 Double Bedrooms, Bathroom, Double Glazing, Electric Heating & Emergency Intercom with pull cords in each room.

Further benefits include: Resident Warden, Communal Laundry Room, Stair Lift, New 99 Year Lease, Guest Suite, Communal Landscaped Gardens and Resident & Visitor Parking. No Upper Chain & completely Redecorated throughout.

Available to persons of 60 years of age & over.

Transport links at both Pinner and North Harrow are accessible with their attendant shopping facilities plus there is a bus stop right outside the development.

Own Front Door

Inner Lobby

Stairs to First Floor (stair lift)

Landing

Lounge

Kitchen

Bedroom One

Bedroom Two





Bathroom

Outside

Landscaped Communal Gardens

Resident Warden

Communal Laundry Room

Guest Suite

New 99 Year Lease

Service Charge £3431.16 pa

Ground Rent £150 pa

Council Tax Band C

Floor Plan

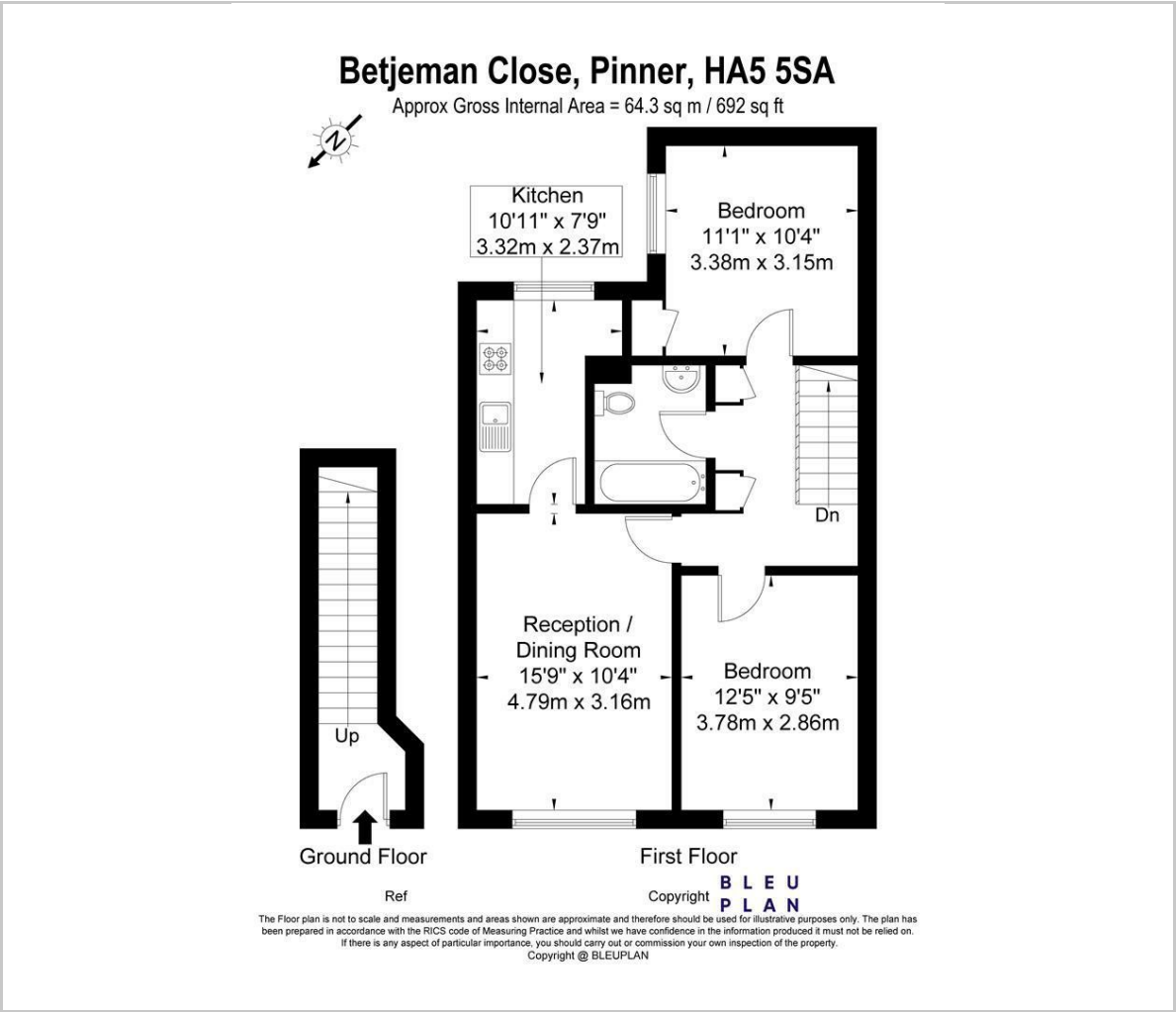

Viewing

Please contact our Harrow on the Hill Office on 020 8422 3333 if you wish to arrange a viewing appointment for this property or require further information.

Area Map

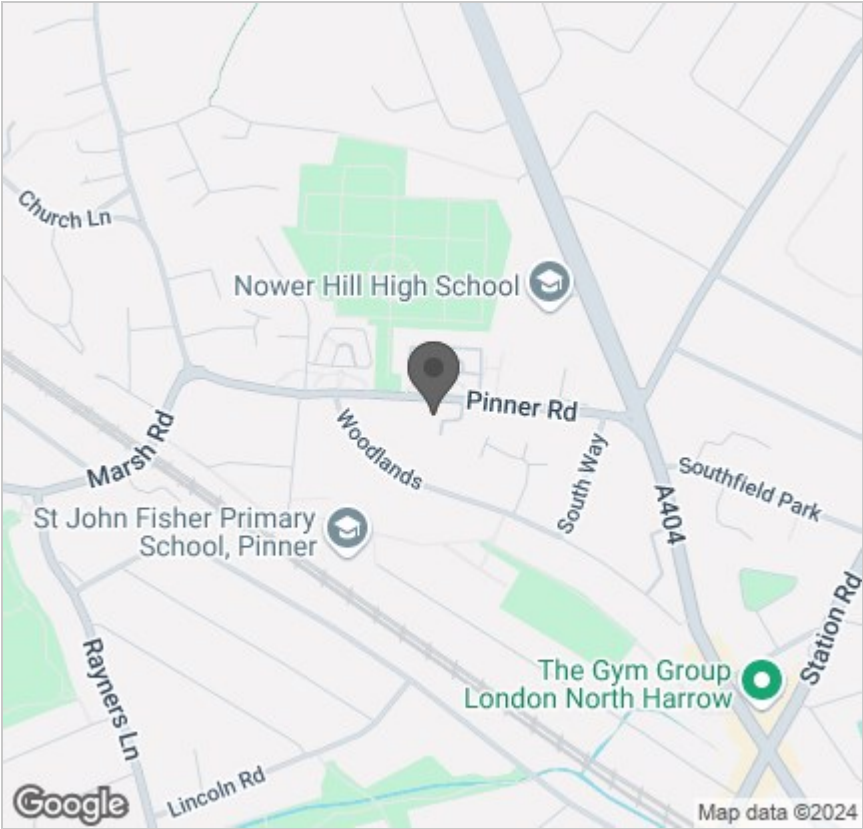

Energy Efficiency Graph

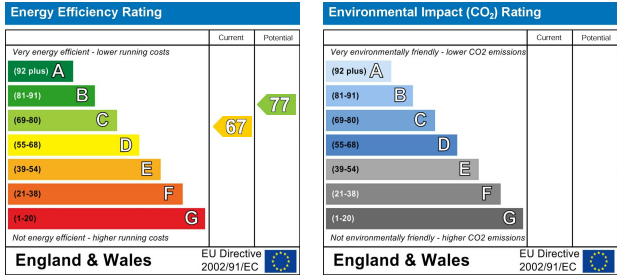

These particulars, whilst believed to be accurate are set out as a general outline only for guidance and do not constitute any part of an offer or contract. Intending purchasers should not rely on them as statements of representation of fact, but must satisfy themselves by inspection or otherwise as to their accuracy. No person in this firms employment has the authority to make or give any representation or warranty in respect of the property.

33-35 High Street, Harrow On The Hill, Harrow, Middlesex, HA1 3HT
Tel: 020 8422 3333 Email: enquiries@wilson-hawkins.co.uk www.wilson-hawkins.co.uk